

暹罗大学英语考试

OXFORD **"On-Site"** PLACEMENT TEST

**** GUIDELINE FOR STUDENTS ****



SIAM
UNIVERSITY

Financial Lab.

9th Edition
(October 2025)

<Exam.Structure '2025>

แบบทดสอบแบ่งออกเป็น 2 ส่วนหลัก

Section 1.

Use of English

(Max. Score =120 points)

- There are 25-30 questions, and time limit for each question will be 30-60 seconds.
- The timer shows how long you have for each question.
- Click Next to move to the next question. You cannot come back once you have clicked Next. !

Section 2.

Listening

(Max. Score =120 points)

- There are 15-18 questions.
- The timer shows how long you have to answer ALL questions.
- Click  to hear the audio. You can listen twice, for each question

,and total time limit
for answering all these questions
will be 45 minutes.



- Click Next to move to the next question. You cannot come back to a question after you click Next. !

*Total Time for both Sections : < 73 Minutes (总考试时间不超过73分钟。)

新的一年 2025

รูปแบบข้อสอบ มี 2 ส่วน (ส่วนละ 120 คะแนน)

(2 Sections)

1.

Section		Part 1	Part 2	Part 3
Use of English 25-30 Questions (Max. Score = 120 points)	Description	Complete a short dialogue with the appropriate grammatical form or lexical item	Read a short dialogue and identify what a speaker means	Type the missing word in gapped text with the appropriate grammar or lexis
	Testing focus	Grammatical form, lexical precision Fill in the Blank	Pragmatics: understanding explicit and implied meaning	Grammatical form, lexical precision
	Response type	Four-option multiple choice	Three-option multiple choice	Gapped text. For A1–C2, test takers <u>type</u> their answers. For Pre–A1, test takers select their answers.
	Questions	Ten tasks	Ten tasks, each with one or two questions	One task, seven questions

Time Limit:
30-60 Sec.
per each question in
Part 1 & Part 2

2.

Listening 15-18 Questions (Max. Score = 120 points)	Description	Listen to a short dialogue and identify what the speaker means	Listen to a longer dialogue and identify what the speaker means	Listen to a monologue and identify what the speaker means
	Testing focus	Pragmatics: understanding explicit and implied meaning		
	Response type	Four-option multiple choice		
	Questions	Five tasks per part, each with one or two questions		

Time Limit:
For all questions
< 45 Mins.

<Exam.Structure '2025>  **Total Time: < 73 Minutes*
 (เวลาสอบ รวมทั้งหมดแล้ว
 ไม่เกิน 73 นาที)

Use of English: The *Use of English* section focuses on grammatical form and meaning.

Part 1 – Focus on form

00:26

Select a word or phrase to complete each conversation.

What a nice car!

I bought it from my uncle.

Wow, it brand new!

suggests shows drives looks

Next

แสดงเวลาที่เหลืออยู่ในการตอบคำถามข้อนี้
Remaining Time for answering this question

(Fill in the Blank)

โดย มีตัวเลือก 4 ตัว ให้เลือกตอบ (แบบข้อสอบปรนัย)
There are 4 choices for answering each question

**“EXAMPLE”
(考试样本)**

Part 2 – Focus on meaning



00:56



Read the conversation. Then select the correct answer from the options below.

Man



Could we have one coffee and two teas, please?

Waitress



I'm sorry. The coffee machine's just being fixed.

What does the waitress mean?

I can make coffee, but not tea.

I can't make coffee at the moment.

I can only make a drink from the machine.

โดย มีตัวเลือก 3 ตัว ให้
เลือกตอบ (แบบข้อสอบปรนัย)
**There are 3 choices for
answering each
question**

แสดงเวลาที่เหลืออยู่ในการตอบ
คำถามข้อนี้
**Remaining Time for
answering this question**

**“EXAMPLE”
(考试样本)**

Part 3 – Focus on form and meaning

(Cloze test) ←

Complete the text. Write ONE word in each space.

Marco Polo **was** born in 1254. He was of the most famous travellers and explorers of the early Middle Ages. His family lived in Venice, and his father was merchant. His mother died when he was young, so he was brought up by his aunt and uncle. He had a good education and studied several languages. he learned little or no Latin. In 1271, when he was just 17 years old he set out with his father a voyage to China. They travelled through Armenia, Persia, and Afghanistan and finally arrived at the court of Kublai Khan four years . Marco Polo spent the next 17 years in China. He worked as an ambassador for Kublai Khan and visited places that no Europeans ever seen before. He finally returned home to Venice in 1295, and a few years later he wrote a book, 'The Travels of Marco Polo'. became very popular and was translated into many different languages.

แสดงเวลาที่เหลืออยู่ในการตอบ
คำถาม แบบมีหลายช่องว่าง ข้อนี้
**Remaining Time for
answering this BIG
question* with multiple
spaces.**

大多数情况下，你必须输入
一个主观答案 - 没有任何选
项

除分数较低的问题外，可能
有答案选项（如第 1 部分和
第 2 部分）

ค่อยกดปุ่ม **Next** ครั้งเดียว หลังจากนักศึกษาเติมคำตอบลงครบทุกช่องว่างแล้ว
**Click 'Next' once only when you have finished filling ALL
the above spaces**

Next

“EXAMPLE”
(考试样本)

Listening Part

The *Listening* section tests how well students can understand communication in different contexts (such as university lectures, going shopping, and business meetings), depending on the CEFR level. There is a focus on explicit and implied meaning. Test takers can listen to each recording twice. !!

每项内容可选择重听一次（共2次）。

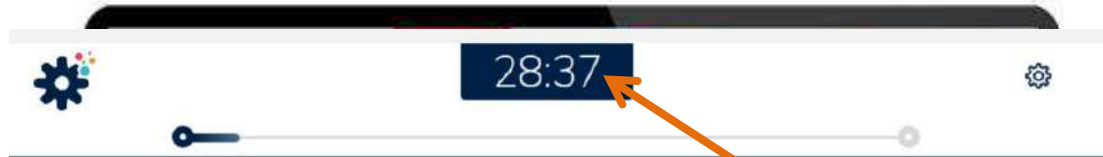

แสดงเวลาที่เหลืออยู่ในการตอบคำถาม ทั้งหมด(15-18 ข้อ) ในหมวดนี้
Remaining Time for answering 15-18 Listening questions

Q: How does the man feel about the trip?

A:

Four answer choices are presented in a light blue box:

- annoyed by the bad service of the airline company
- disappointed at the short time he had to see things
- pleased with one of the places he visited
- delighted by a meal he had

โดย มีตัวเลือก 4 ตัว ให้เลือกตอบ (แบบข้อสอบปรนัย)

There are 4 choices for answering each question

**“EXAMPLE”
(考试样本)**

ขั้นตอนการสอบ { How to Begin this English Test... }

1. พิมพ์ <https://www.oxfordenglishtesting.com/login> และกรอกข้อมูลรหัสสอบ Username, Password และ Organisation ID ตามที่ได้รับ และเมื่อกรอกเสร็จให้คลิก Sign In ต่อไป

คำแนะนํ หากกรอกรหัสผิดเกิน 5 ครั้งระบบจะล็อกอัตโนมัติทันที รหัสสอบเป็นอักษรภาษาอังกฤษ จะมีทั้ง ตัวพิมพ์ใหญ่ ตัวพิมพ์เล็ก และ ตัวเลข หากไม่แน่ใจสามารถพิมพ์ Password ใน Word หรือ Excel แล้ว Copy ไปวางได้

*****Please carefully key in both User name and Password. Do not type them wrongly more than 5 times !**

(1. Sign in)

The image shows the login interface for the Oxford English Testing system. On the left, there is an 'EXAMPLE' card with the following details: Student name: Student 001 Group 786266, Student ID: u7337040, Password: s6cZnAr, and Org ID: 026. On the right, the 'Sign in to your account' form is visible. It includes fields for Username (u7337040), Password (masked with dots), and a checkbox for 'I have an organisation ID' (checked) with the value 025130. The 'Sign in' button is circled in red. A blue arrow points to the 'Sign in' button, and a red arrow points to the 'Org.ID' field. A red arrow also points from the 'EXAMPLE' card to the 'Sign in' button.

* 学生只需点击“登录”即可，无需输入任何其他代码。

NOTE: *No need for student to type anything , just click “Sign in” here

2.



(2. Register, in English language)

* 请用英文输入您的资料。

Sign out

Welcome to oxfordenglishtesting.com

Welcome to oxfordenglishtesting.com

Our Privacy Policy sets out how Oxford University Press handles your personal information, and your rights to object to your personal information being used for marketing to you or being processed as part of our business activities.

We will only use your personal information for providing you with this service.

Before starting your placement test, please complete or confirm this information.

First name	<input type="text"/>
Last name	<input type="text" value="and (Student ID)"/>
Email	<input type="text"/>
Gender	<input type="text" value="please choose"/>
Study Level	<input type="text"/>
Study Program	<input type="text"/>
Student ID	<input type="text"/>

save



มหาวิทยาลัยสยาม
Siam University

If your usual E-mail is not accepted,
you can use/type **any dummy E-mail**
for instead ^+^

Thai or
English or
Chinese

Please also type your **Student ID No.** with a bracket ,following your Last name in this box i.e. **Smith (6417190031)**

* กรุณาพิมพ์รหัสประจำตัวนักศึกษาของท่าน แบบใส่ในวงเล็บ ต่อท้ายนามสกุลของท่านด้วย เพื่อให้ตัวเลขไปปรากฏในใบรับรองผลสอบ เมื่อท่านสอบผ่าน*

3. ระบบจะเข้าไปสู่หน้า My test หลังจากนั้นให้คลิกลิงก์ Oxford Online Placement Test ตามรูป

The screenshot shows a web interface titled "My tests". At the top, there are two tabs: "My Tests" and "Results". The "Results" tab is crossed out with a red 'X' and has red text overlaid: "**ห้ามกด Results ก่อนทำข้อสอบ โดยเด็ดขาด !!!". Below the tabs, there is a section titled "My tests" with a sub-header "Click test name to start (Please note: Pop-ups are required to start the test)". A table lists the available tests:

Test	Expiry date	Status
Oxford Online Placement Test	07/06/2020 23:59	Not started

The "Oxford Online Placement Test" entry is circled in red. A red arrow points from the "Results" tab area down to the table, and an orange arrow points from the circled test name down to the text "(3. Enter the Test System)".

(3. Enter the Test System)

= The level of your First question Today !

(4. Select your Starting Level)

4 เลือกระดับเริ่มต้นของแบบทดสอบ

ระบบจะให้เลือกจุดเริ่มต้นของข้อสอบ โดยสามารถเลือกระดับด้วยตนเอง (ตามความยาก-ง่าย ที่ผู้เข้าสอบต้องการ) หากไม่แน่ใจ ให้เลือก "Computer chooses for you" เพื่อให้ระบบเลือกให้อัตโนมัติ



***This Exam. is running under "Adaptive Test" system which means... after checking your answer in each question, the computer system will adjust the degree of difficulty in your next question(s) ,to be either harder or easier, automatically !!**

Please select your starting difficulty from the options below. The test will begin at this difficulty level, but will automatically adapt based on your performance as the test progresses.

a)

Computer chooses for you



b)

Low

Easy question,
but Low score ^^

c)

Medium

Medium question,
Medium score

d)

High

Difficult question,
but High score ++



Next

REMARKS :

Choose from the options below to select your starting level for this test;

- ☐ Please choose a starting point for me = Computer chooses for you
- ☒ Lower level starting point – for beginner and elementary students = Low
- ☐ Mid-level starting point – for pre-intermediate and intermediate students = Medium
- ☐ Higher level starting point – for upper-intermediate and advanced students = High

Next >

调整考试期间的背景颜色、文字大小和音量。

How to adjust your Screen Background Color, Fonts Size and Sound Volume.

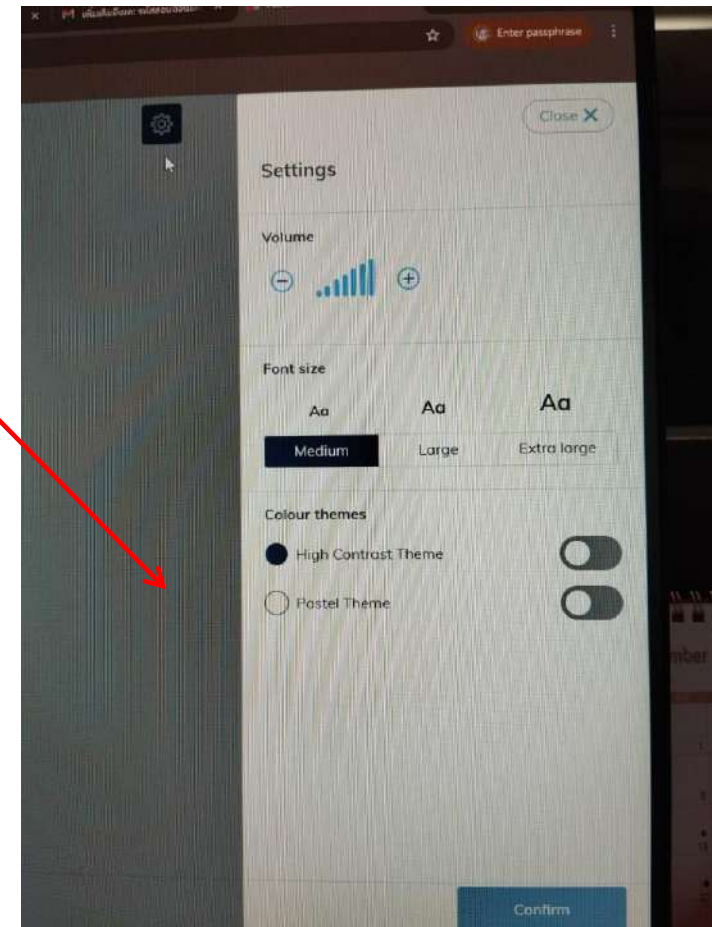
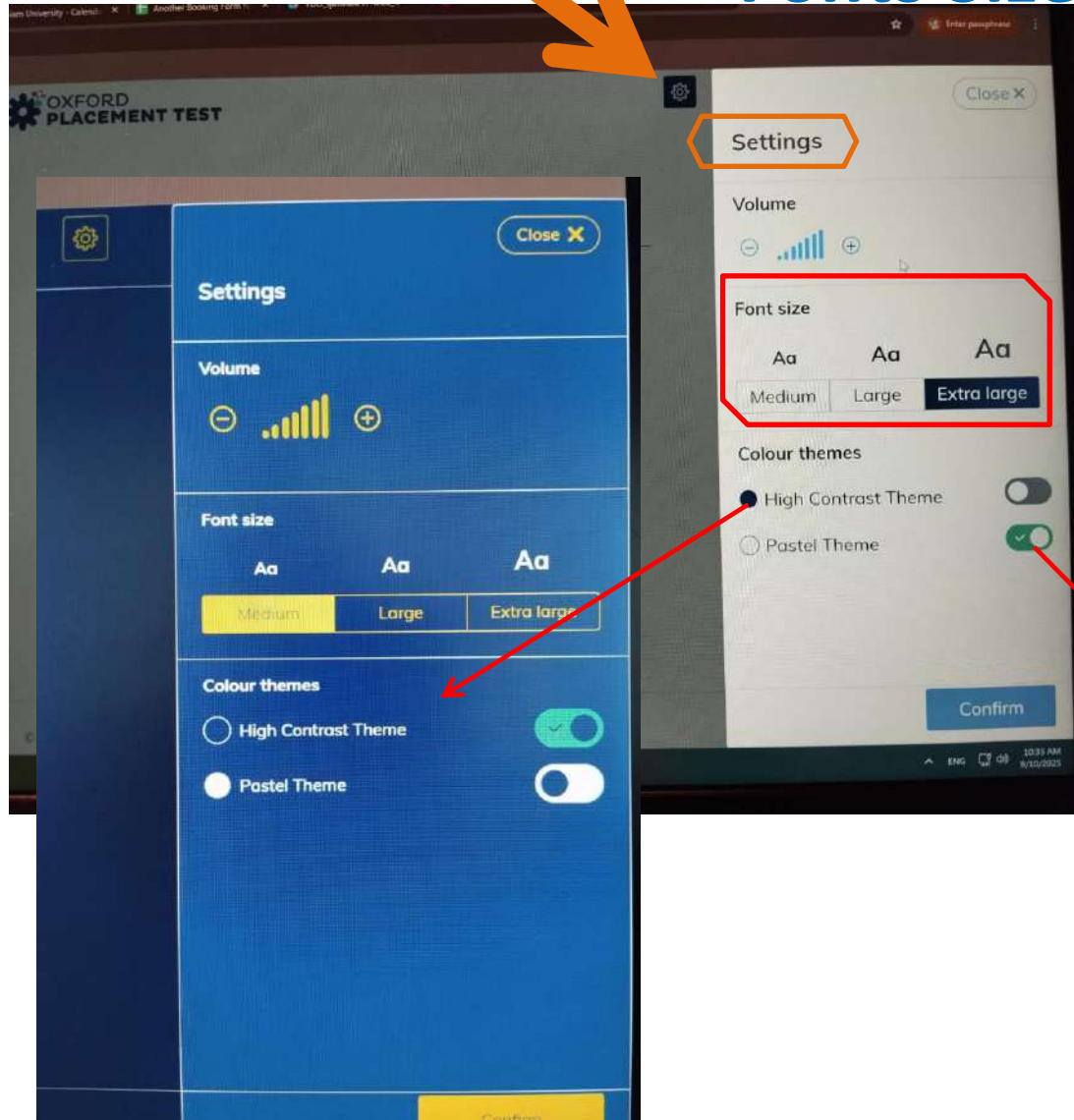

Rules & Regulations for Our “On-Site” Exam.

- ❖ 1. All types of Dictionary/e-Dictionary(English-to-Chinese /English-to-Thai/...etc.) are **NOT ALLOWED** to be used in the exam room.
- ❖ 2. Laptop computer/ tablet PC/ smartphone/ smart watch/ smart glasses/... or any other IT /communication /smart devices **are ALL NOT ALLOWED** to be used in the exam room.
- ❖ 3. All types of Camera/Video Recorders **are NOT ALLOWED** to be used in the exam room.
- ❖ ***In case of any misconduct /disobedience or cheating behavior of any student(s) found in the exam. room or during the exam period. => **That student will automatically get the exam. result “Not Pass” and then be “banned” from taking our English Test/exam. for 3 Months !!!**
=> 该学生将自动获得考试结果“不通过”，然后被“禁止”参加我们的英语测验/考试。3个月！！！！



For your kind understanding and co-operation !!.

(5. Finish and Complete your Test)

5. ส่งคำตอบหลังทำข้อสอบเสร็จสิ้น

หลังจากทำข้อสอบครบทุกข้อแล้ว ระบบจะแสดงข้อความดังนี้: "You have finished your test" → ให้คลิกปุ่ม Next ถัดไปจะปรากฏข้อความ "You have answered all the questions" → ให้คลิกปุ่ม Finish ระบบจะบันทึกคำตอบและส่งผลสอบเข้าสู่ระบบอัตโนมัติ

1 You have finished your test.



2 You have answered all the questions
Select Finish to submit your answers and complete your test

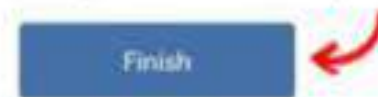

Whenever you finish your Test, please raise your hand, and then wait for the Test Instructor.

CAUTION : You **MUST** finish the last question within the given Time (Total < 73 Minutes, as earlier mentioned)

**** If NOT., your Score in Section 2. may be reset to Zero !!!**

如果不是...，您在第 2 部分的分数可能会被重置为零！！！！

6.

วิธีการตรวจสอบผลการทดสอบ

(6. Check your Scores & Test Result)

เมื่อทำการสอบเสร็จแล้ว ผู้สอบสามารถเข้าไปดูผลการสอบได้ด้วยตัวเองได้โดยทำการ Log in เข้าไปอีกครั้ง แล้วคลิก

เลือก **Results** ต่อไปคลิกที่ลิงก์ Oxford Online Placement Test ตามรูปตามลำดับ

OXFORD
UNIVERSITY PRESS

Sign out

Results

My Tests

Results

Pass ++ OR Not Pass ^^ ,Check Here!!!

Results

Click on the test name to see your marks. Marks will usually be available within a few minutes of finishing a test, so check back here again if required.

Group	Mode	Date set	Notes
Oxford Online Placement Test	2020-01 M 2.5 Test	30/01/2020	Whole test marked and complete

Click to view the marked test, papers or parts

Component	Score	Time taken	CEF	Note	Date taken	Status
Oxford Online Placement Test	48	00:51	B1	Hover over to view additional information...	2020-02-06 08:34	Normal
Use of English:	45	00:21	B1	Hover over to view additional information...		
Section 1: Approximately 30 Questions						
Listening:	50	00:29	B1	Hover over to view additional information...		
Section 2: Approximately 15 Questions						

In addition to competencies from previous levels, can typically, in formal and appropriate social settings, e.g. technology, conduct affairs.

- understand extended meanings
- understand simple meanings implied within or beyond the text
- understand skilful and interpersonal relations
- understand expression of pleasure, warning, reason, agreement
- use all basic and a range of complex grammatical forms, sometimes with errors, to communicate ideas of and intended meanings
- use medium frequency vocabulary, sometimes with errors
- use a range of linking words and phrases
- use informal register effectively and without undue politeness

download

print

Your score in each Section (Maximum scores are 120 points)

○ = Your Final score (*average score of Section 1 and Section 2)

你的最终成绩

第 1 部分和第 2 部分的平均分数

เกณฑ์ในการสอบผ่าน (Latest Passing Criteria)



Ph.D, DBA , Master D. (**English** Program)

Master Degree (**Thai, Chinese** Program)

Bachelor Degree (**Pharmacy** Program)

C2	CEFR	Score	
	C2 ←-----→	101-120	
C1	C1	81-100	
B2	B2	61-80	Final score
B1	B1	41-60	55 or above *
A2	A2	21-40	45 or above *
	A1 ←-----→	1-20	
A1	Pre-A1 High	0.7-0.9	
	Pre-A1 Mid	0.4-0.6	
Pre-A1	Pre-A1 Low	0.1-0.3	

注：*请参阅关于批准牛津大学 OPT 考试附加研究生英语语言能力标准的备忘录（于 2020 年 11 月 24 日批准）

* Based on Siam University [Memo \(on November, 24th 2020\)](#) about English Test Scores for each Graduate School

*如果您通过了考试标准，中心将颁发正式的考试成绩证书。您可以从下周周四起，周二至周六下午1点至5点之间到金融实验室（19号楼6楼）领取文件。

* In case you pass the Test Criteria of your Study Program, your Official Test Certificate (A4-sized Document) will be available from Thursday of the following week
You can therefore come back and ask for that document at our Financial Lab (on the 6th floor of Building 19) during 13:00-17:00 hrs. on Tuesday-Saturday

ANY PROBLEM DURING THIS TEST, PLEASE RAISE YOUR HAND!
考试过程中如遇到任何问题，请立即举手告知监考老师

“THANK YOU”

“谢谢”